

Technical specifications: TM-31 (DKS-32)



High capacity and heavy duty compressor
 -Smooth operation
 -High efficiency and durability
 -Optimized lubrication system with oil pump and sight glass



www.valeocompressors.com

MODEL	TM-31/ DKS-32
DISPLACEMENT	313cm ³ /rev.
NUMBER OF CYLINDERS	10
RANGE	700-6000
REFRIGERANT	HFC-134a
OIL	ZXL 100PG 500cm ³
WEIGHT	15.5Kg (with clutch)
MOUNT	Direct

PERFORMANCE CURVES: TM-31/ DKS 32

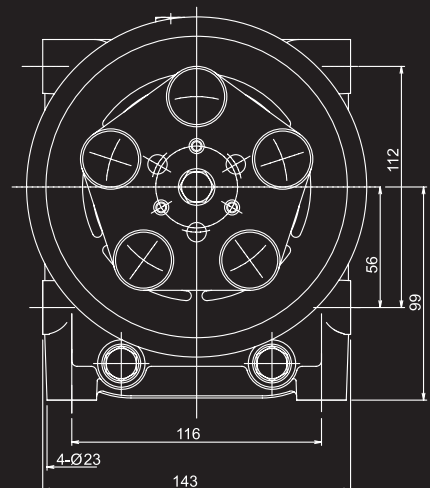
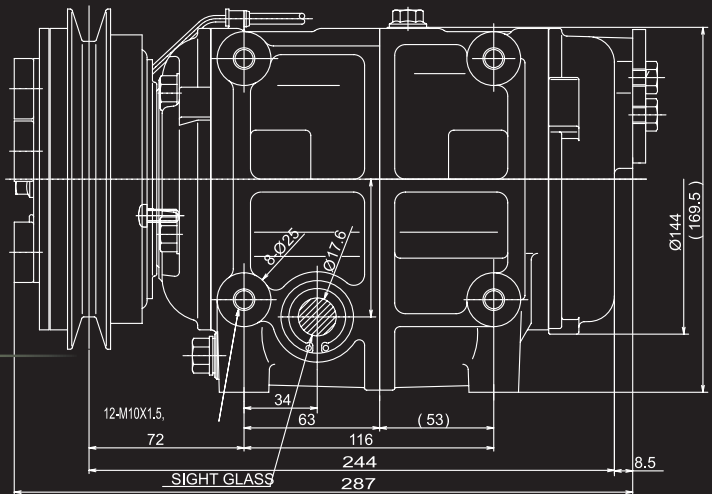
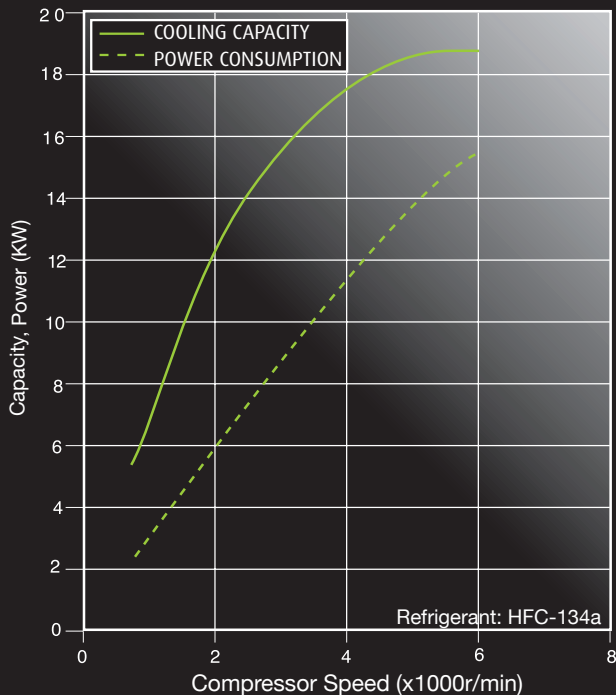

TEST CONDITIONS

Discharge pressure: 1.52MPa (gage)
 Suction pressure : 0.18MPa (gage)
 Sub cool :5°C Super heat : 10°C

MAGNETIC CLUTCH VARIATIONS

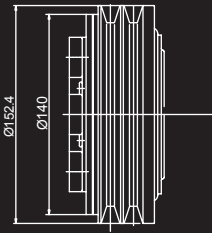

151-2AG

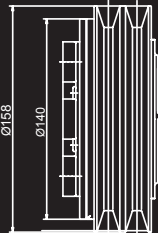

156-2BG

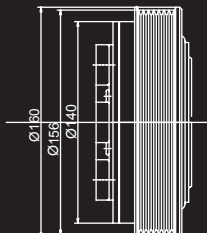

156-6PK

SUCTION & DISCHARGE CONNECTORS

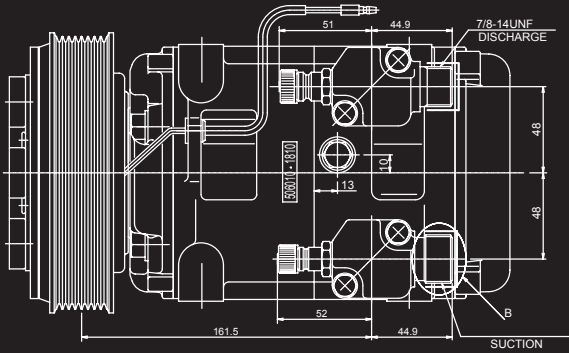

Connectors with Charges Nipple

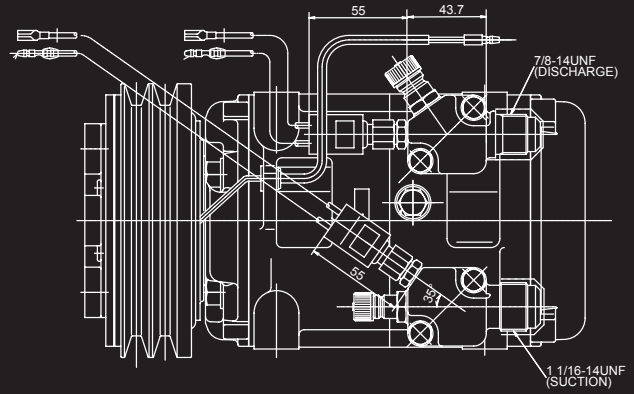

Connectors with Pressure Switch